



TBR

ENGINEERING

STOP BOWING FOUNDATION WALLS WITH IMBEDDED FIBER REINFORCEMENT

STRONG, SEAMLESS, AND RELIABLE

Bowing foundation walls are common in the Greater Toledo area—but there's a smart solution.

Our Imbedded Fiber Reinforcement strengthens your walls without sacrificing aesthetics.

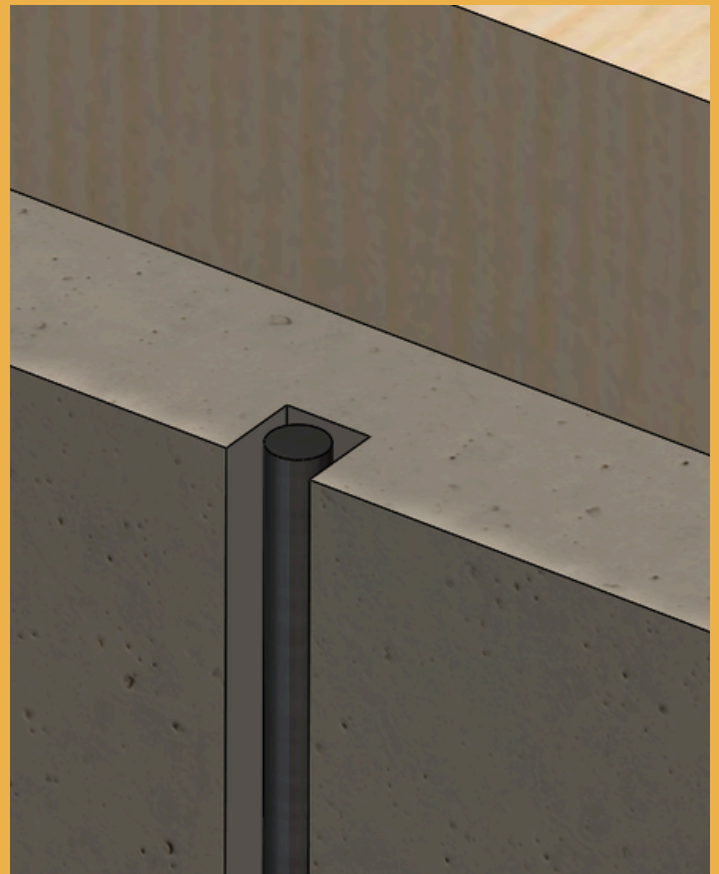

Contact us today! (419-464-9994) tbengineering.com



TBR

ENGINEERING

WHY CHOOSE IMBEDDED FIBER REINFORCEMENT

Virtually Invisible

Unlike steel beams, our vertical strips sit flush with your wall and are easily paintable. Once installed, it's hard to tell any work was done!

Maximum Strength

The strips run the full height of the wall, drilled into the block below the floor joint, and bonded with epoxy to tie each mortar joint together. This significantly boosts tensile and shear strength, making your wall much harder to push inward.

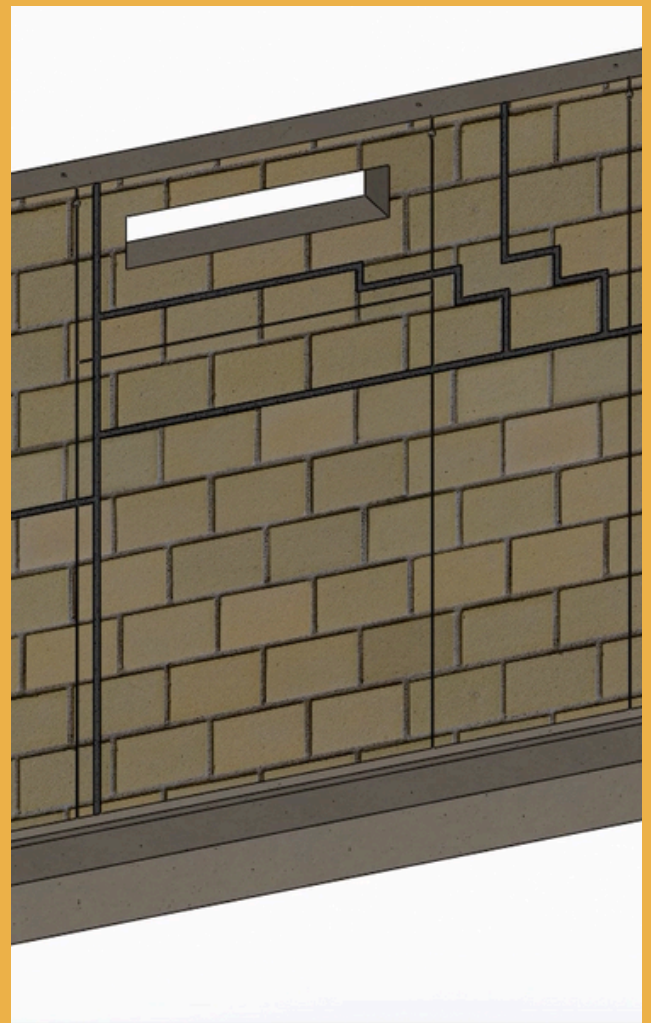

Contact us today! (419-464-9994) tbrengineering.com



TBR

ENGINEERING

WHY CHOOSE IMBEDDED FIBER REINFORCEMENT

Versatile Application

Ideal for block foundations and sometimes poured walls.

Proven Results

Recommended for walls with deflection under 2 inches—excavation and wall re-alignment may be advised for best results.

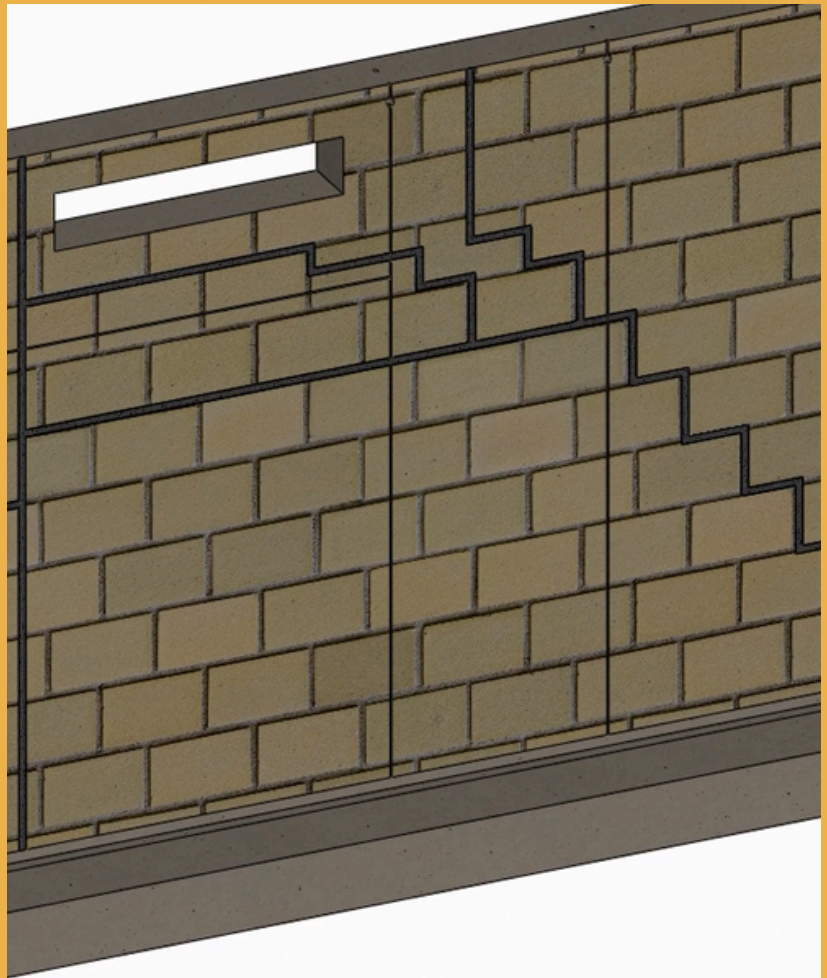

Contact us today! (419-464-9994) tbrengineering.com



TBR

ENGINEERING

Protect Your Home Today!

Increase your foundation's durability, improve wall stability, and maintain a clean, finished look with our mid-tier Imbedded Fiber Reinforcement.



Contact us today! (419-464-9994)



Visit our website
tbengineering.com